



## WFOI TB-3209 - INSTALLATION INSTRUCTIONS

Part #	Description
WFO TB-3209	2005 – 2015 Toyota Tacoma Front HD Track Bar

10076 Streeter Road Suite #7, Auburn, CA 95602  
Phone: 530.268.9494    www.wfoconcepts.com

### WFO TB-3209

BILL OF MATERIALS	
Qty. 1 – WM-13010	Track Bar Tube
Qty. 1 - FK HRSMXR12T	7/8" x 3/4"-14 Heim
Qty. 1 – JN0875-14R	7/8"-14 RH Jam Nut
Qty. 2 - WFO 5040	7/8" to 14MM Misalignment
Qty. 2 - M8501002-BK	3/8" Wobble Stopper Bushing
Qty. 2 - M8501004-BK	1/4" Wobble Stopper Bushing
M14 10.9 Bolt Kit	M14-1.5x80mm bolt, washers & nylock
3/4" Grade 8 Bolt Kit	3/4"-16x3.5" bolt, washers, & nylock
TOOLS NEEDED	
Floor Jack and Jack Stands Metric Socket Set: 21mm Metric Wrench Set: 24mm Standard Socket Set: 1-1/8" Standard Wrench: 1-1/8", 1-1/4" Large Adjustable Wrench Pry Bar Impact gun Torque Wrench Tape Measure Straight edge or 4' Level	

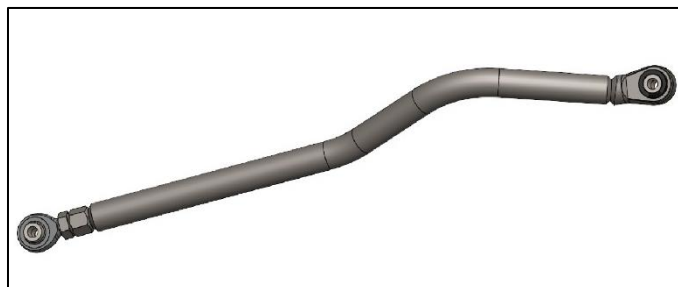

### WARNING!

- \*\*\* Read all instructions thoroughly from start to finish before beginning the job! If these instructions are not properly followed, severe frame, suspension, tire, or body damage may result to the vehicle!
- \*\*\* WFO Concepts recommends that you exercise extreme caution when working under vehicles supported by jack stands.
- \*\*\* WFO Concepts recommends all installation to be performed by a professional shop/service technician. Product failure due to improper installation will not be covered under WFO's warranty policy.
- \*\*\* Whenever altering steering and suspension components it is always recommended to get a professional alignment afterwards \*\*\*

### TECH NOTES:

- This track bar will only fit our SAS kit for the 2005 – 2015 Toyota Tacoma's with either stock F-250 or crossover steering setups.
- WFO Suspension Components should be installed on a well-supported vehicle. Either supported by using appropriately rated jack stands under the front and rear frame rails OR by using an automotive lift.

## INSTALL:

1. Initially set the length of the track bar to 39" hole to hole.
2. Insert the uni-ball side of the track bar into the upper frame side track bar bracket. Make sure the bend of the bar is up and forward when installed into the vehicle. Also make sure that the anti-wobble bushings are on the correct side. The thinner bushing is on the front most side and the thicker bushing goes towards the back. Locate your M14 bolt, washers, and nylock nut to hold it in place. Do not tighten yet.
3. For the axle side, determine what steering setup you are running to choose the correct hole in the axle side 2 bolt hole bracket.
  - The lower hole is for if you are running your draglink down to the stock location on the knuckle.
  - The upper hole is for if you are running crossover steering, which you will be attaching your draglink to the bottom side of a steering arm.
4. Locate the 3/4"-16x3.5" bolt, washers, and nylock nut to hold the lower heim in place. Do not tighten yet.
5. It's always a good idea to double check clearances. When ready, cycle your suspension to make sure everything clears from full bump to full extension.
6. Before final install, either paint or powder coat the track bar. If powder coating, you will need to remove both the heim and uni-ball from the bar. Remember to note your length for re assemble.
7. **Always get a professional alignment after any steering or suspension modifications.** But to get you close, set the truck back onto the ground on its own weight. Using a straight edge like a 4' level and a tape measure, set the level on the outside of the tire and measure to a solid point on the frame. Using the same technique, repeat on the other side. Adjust accordingly.
8. Tighten the upper M14 bolt to 160 ft. lbs. and the lower 3/4" bolt to 220 ft lbs. Tighten lower jam once set.

Fig. A

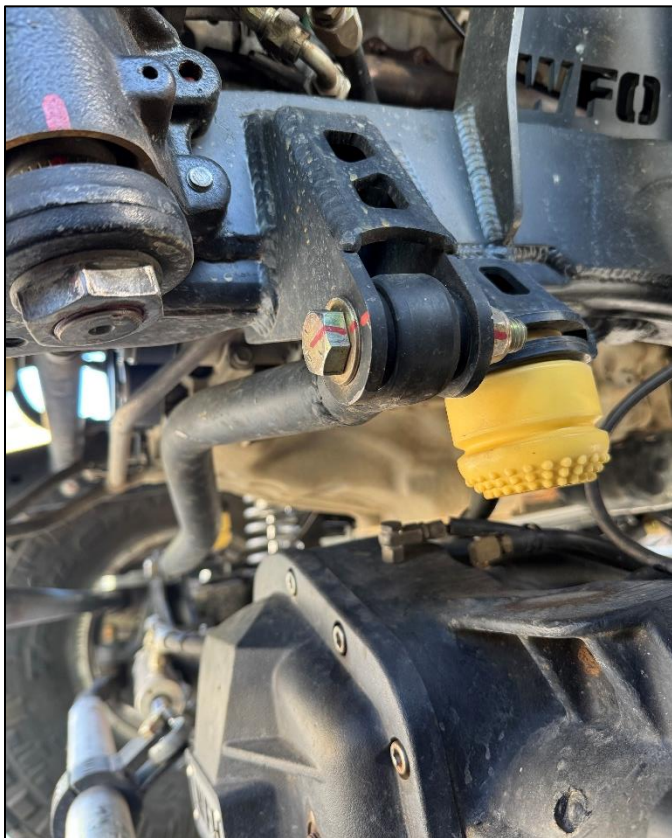
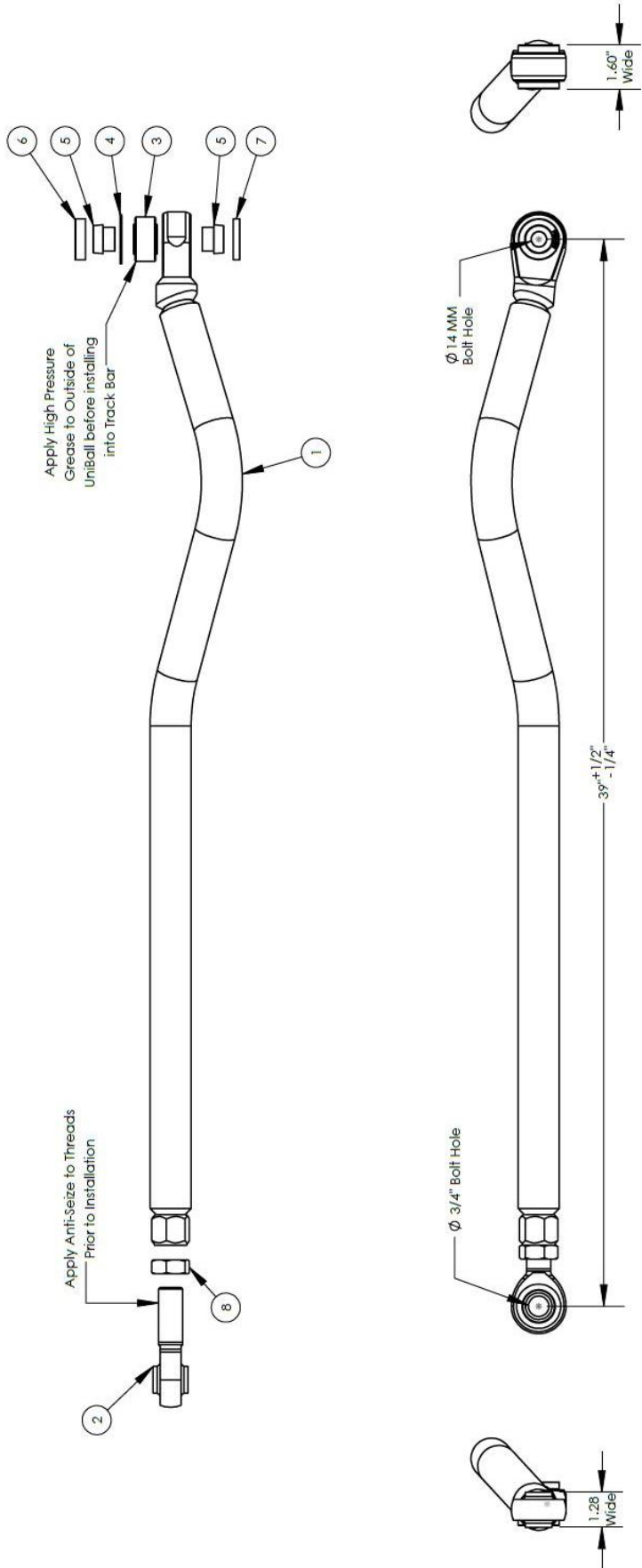

Fig. B



QTY.	DESCRIPTION	PART NUMBER
1	2005-2015 Toyota Tacoma Track Bar	WM-13010
1	7/8"-14 RH Thread x 3/4" Hole with High Misalignment built in	FK HR3MX12T
1	1-5/8" DO x 7/8" ID Uni Ball	AIN14T-770 - Assembly
1	Internal Retaining Ring for FK AIN14T-770	99142A560
2	Straight Heim Spacer - 7/8" to 1.4M Bolt Hole	WFO 5040
1	1" ID / 1.5" OD x 3/8" Wobble Stopper Bushing	M8501002-BK
1	1" ID / 1.5" OD x 1/4" Wobble Stopper Bushing	M8501004-BK
1	7/8"-14 Right Hand Jam Nut	WFO JN0875-14R

REVISIONS			
REV.	DESCRIPTION	DATE	APPR
A	Part Released	4/2/2025	Kevin



DRAWN BY: KEVIN K WEIGHT: 11.6 LBS	DATE: 8/27/24 DWG UPDT: 4/2/2025	MATERIAL: 1.5"x.25" DOM FINISH: RAW / WIRE WHEEL	TOLERANCES / DIMENSIONS ARE IN INCHES EXCEPT AS NOTED: ANGULAR ±0.1° BEND ±0.5° DEC: 2PL ±0.01 3PL ±0.005	 10076 Steeler Rd. Auburn, CA Phone: 530.221.5522 WWW.WFOCONCEPTS.COM
THE INFORMATION CONTAINED IN THIS DRAWING IS THE SOLE PROPERTY OF WFO CONCEPTS. ANY REPRODUCTION IN PART OR AS A WHOLE WITHOUT THE WRITTEN PERMISSION OF WFO IS PROHIBITED.				<b>TITLE:</b> 2005 - 2015 Toyota Tacoma Front Track Bar
DO NOT SCALE DRAWING				<b>PART #</b> WFO TB-3209 <b>REV</b>



10076 Streeter Road Suite #7, Auburn, CA 95602

Phone: 530.268.9494 [www.wfoconcepts.com](http://www.wfoconcepts.com)

**Follow us on all Social Media Platforms!**

**Remember to share your photos and tag #WFOCONCEPTS to be featured on our page!**

